

Contour next link

Wireless Blood Glucose Monitoring System



Uses only CONTOUR®NEXT blood glucose test strips



ASCENSIA Diabetes Care



Medtronic

QUICK REFERENCE GUIDE



TOP VIEW

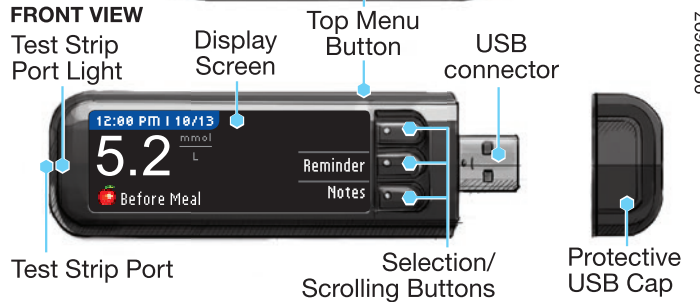

Note: Check the units of measure of your meter. See your meter user guide for complete instructions.

90003697 Rev. 05/19

Initial Setup of the Meter and Connection to Compatible Medtronic Device

Charging the Meter

1 Remove the USB cap to reveal the USB connector.

The CONTOUR®NEXT LINK meter has a permanent rechargeable battery.

Charge your meter with the wall charger* or by plugging the USB connector into a computer. Make sure the computer is turned on.

Your meter will briefly display "Do Not Test-Charging" and the test strip port light will flash. **You cannot do a blood glucose test while the battery is charging.** When charging is finished, the test strip port light will turn off. Unplug your CONTOUR NEXT LINK meter to test.



Unplug Meter From Charging Source Before Beginning Setup

2 To begin setup, hold down top Menu button for several seconds until the meter turns on.



3 Scroll down to select your language and press OK.

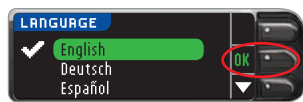

This screen example shows the language selections. The language order may differ depending on your country.

Press **OK** if the correct language is displayed. Press **NO** if the incorrect language is displayed.

4 Press OK to begin the connection process. **NOTE:** Pump refers to your compatible Medtronic device.

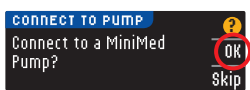

5 STOP. Do NOT press ANY buttons. This screen displays the meter ID number (in the bottom left corner). This ID is needed to complete the connection process. Put down your meter. Pick up the compatible Medtronic device and continue with Step 6.

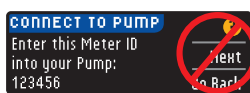

Connecting Meter to MiniMed™ Paradigm™ Insulin Pump

6 Press ACT to go to the MAIN MENU. Scroll to Utilities by pressing the down arrow. Press ACT.



7 Scroll to Connect Devices and press ACT. Then scroll to Meters and press ACT. **Note:** If your UTILITIES MENU does not contain Connect Devices, scroll to Meter Options and press ACT.

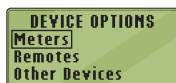

8 Select On and press ACT. If you are replacing a meter, go to Step 9. If you are adding a new meter, go to Step 11.



9 To replace a meter, select Delete ID and press ACT.



10 If you have multiple meter IDs, repeat Step 9 for each one.



? = Help

11 To add a new meter, select Add ID and press ACT. Refer to Step 5 (or see meter back) to find meter ID. Use the up and down arrow buttons to enter the six character meter ID (SN) shown on the meter screen. Press ACT after each character entry.



12 Select Review ID on your compatible Medtronic device to confirm that your CONTOUR®NEXT LINK meter ID has been correctly entered. If incorrect, go back to Step 9.



NOTE: For detailed instructions, see your compatible Medtronic device user guide.

13 Return to your CONTOUR NEXT LINK meter. After you have entered the meter ID into your compatible Medtronic device, press Next.

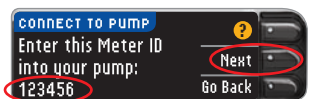

Choosing Meter Send Options

14 SEND OPTIONS controls how your meter will send blood glucose readings to your compatible Medtronic device.

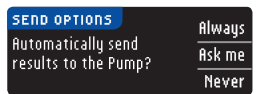

Choose the **SEND OPTION** that is best for you.
Always = Meter will always send results.
Ask Me = Meter will ask you before sending results.
Never = Meter will never send results.

Set Meter Date/Time to Match Medtronic Device

15 The date and time on your meter must match the date and time on your Medtronic device. Pick up Medtronic device. Press ACT to go to the MAIN MENU. Scroll to Utilities and press ACT. Scroll to Time/Date and press ACT. Select a time format and press ACT. Note the time and date. Return to your meter. Follow instructions on your meter to change the time and date to match your Medtronic device.



Additional Meter Settings

16 Press Accept to select AutoLog is Off. AutoLog allows you to mark a test result as Fasting, Before Meal, After Meal or No Mark. See your user guide to learn more.

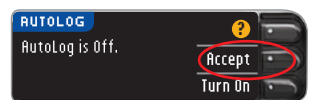

17 Accept or Change High and Low Alerts. The meter alerts you with a sound when your blood sugar level is above or below your set levels.



18 Accept or Change your Target range. The Target range is your goal for your blood sugar test results.

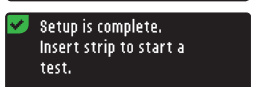

NOTE: Alerts can only be set outside your selected Target Range(s). Targets can only be set inside your selected Alert level(s). For additional information, you may contact Customer Service. Contact information for Customer Service is on the next page.

SETUP IS NOW COMPLETE!

Turn the page over to see testing instructions. ➔

*Charger is available separately from Customer Service if not included in your meter kit. See contact information for Customer Service on opposite page.

Materials for Testing



CONTOUR®NEXT test strips



Lancing Device



Lancets



CONTOUR®NEXT LINK blood glucose meter

⚠ WARNING:

- The lancing device is intended for self-testing by a single patient. It must not be used on more than one person due to the risk of infection.^{1,2}
- Use a new lancet each time you test because it is no longer sterile after use.
- All parts of the kit are considered biohazardous and can potentially transmit infectious diseases, even after you have performed cleaning.
- Always wash your hands well with soap and water and dry them well before and after testing, handling the meter, lancing device, or test strips.

For complete instructions on cleaning your meter, please see your meter user guide.

Testing Your Blood

Obtaining the Blood Drop

- 1** From any screen, insert test strip and wait for **APPLY BLOOD** message.

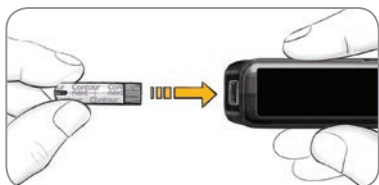

- 2** Remove the lancing device endcap. Insert the lancet firmly into the lancing device until it comes to a full stop.

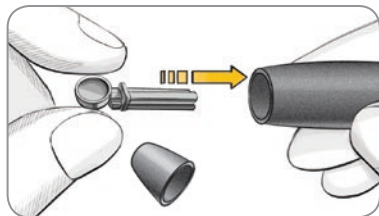

The lancing device graphics are for illustration purposes only. Your lancing device may look different. Refer to your lancing device insert for detailed instructions on preparing the lancing device.

- 3** Replace the endcap. Rotate the endcap dial to adjust the puncture depth.

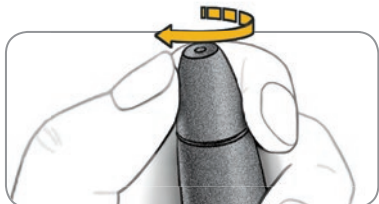

- 4** Obtain your blood drop.



Testing the Blood Drop

- 5** Touch the tip of the test strip to the drop of blood. If the first blood drop is not enough, the meter will beep twice and display **STRIP UNDERFILLED**. You have about 30 seconds to apply more blood to the same strip.



- 6** If AUTOLOG is on, you can choose to record your result as: **Fasting**, **Before Meal**, **After Meal** or **No Mark** for the test result.



NOTE: If your result is above your High Alert setting or below your Low Alert setting, you will see your result without having to make an AutoLog selection.

References

- 1 US Food and Drug Administration. Use of fingerstick devices on more than one person poses risk for transmitting bloodborne pathogens: initial communication. US Department of Health and Human Services; update 11/29/2010. <http://www.fda.gov/MedicalDevices/Safety/AlertsandNotices/ucm224025.htm>
- 2 Centers for Disease Control and Prevention. CDC clinical reminder: use of fingerstick devices on more than one person poses risk for transmitting bloodborne pathogens. US Department of Health and Human Services; 8/23/2010. <http://www.cdc.gov/injectionsafety/Fingerstick-DevicesBGM.html>

Sending Results to Your Compatible Medtronic Device

- 7** If **Always** was selected in **Send Options** during **Setup**, results will be sent directly to your pump. If **Ask Me** was selected in **Send Options** during **Setup**, you can choose to send your result to your pump after each blood sugar test. Press **Send** or **Don't Send**.



Press **OK** to move to the next screen.



CAUTION: Always check the display on your pump to ensure that the glucose result shown agrees with the glucose result shown on the meter.

Reminder and Notes

- 8** Select **Reminder** to set a reminder for your next test. Select **Notes** to add more information to the result. Remove test strip.



Turn Meter Off

- 9** Remove the test strip and the meter will turn off in 3 minutes. Or hold down the Menu button to turn off the meter.



See your CONTOUR NEXT LINK user guide, lancing device insert and compatible Medtronic device user guide for full instructions.

Customer Service is available from 9:00 AM to 5:00 PM Australian Eastern Standard Time, Monday to Friday at 1-800-289-312.

www.diabetes.ascensia.com

For information on patents, and related licenses, see: www.patents.ascensia.com

IVD For In Vitro Diagnostic Use

Ascensia Diabetes Care Holdings AG
Peter Merian-Strasse 90
4052 Basel, Switzerland

Ascensia Diabetes Care Australia Pty Ltd
Suite 6, Level 3
25 Solent Circuit, Baulkham Hills
2153 NSW Australia
Ph: 1-800-289-312
www.diabetes.ascensia.com.au



Medtronic

Ascensia, the Ascensia Diabetes Care logo, Clinilog, Contour, Glucofacts, and the No Coding logo are trademarks and/or registered trademarks of Ascensia Diabetes Care Holdings AG.

Medtronic, the Medtronic logo, MiniMed, and Paradigm are trademarks of Medtronic.

© 2019 Ascensia Diabetes Care Holdings AG. All rights reserved.